

## coupe A-A

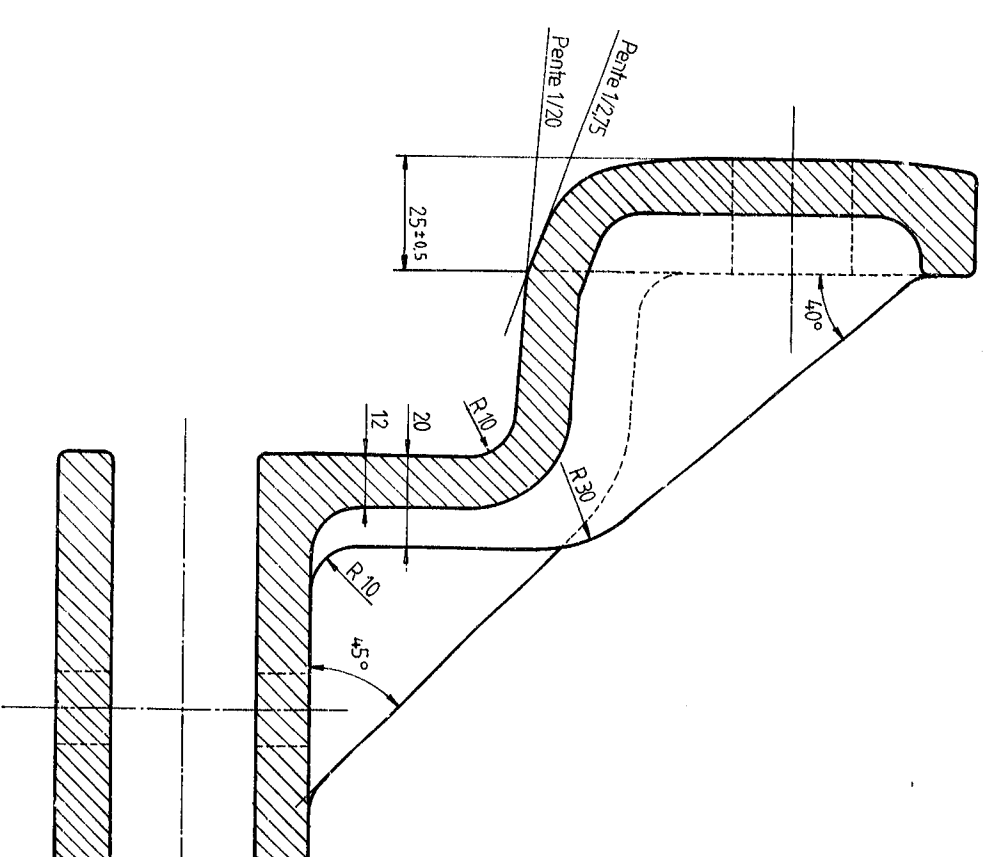
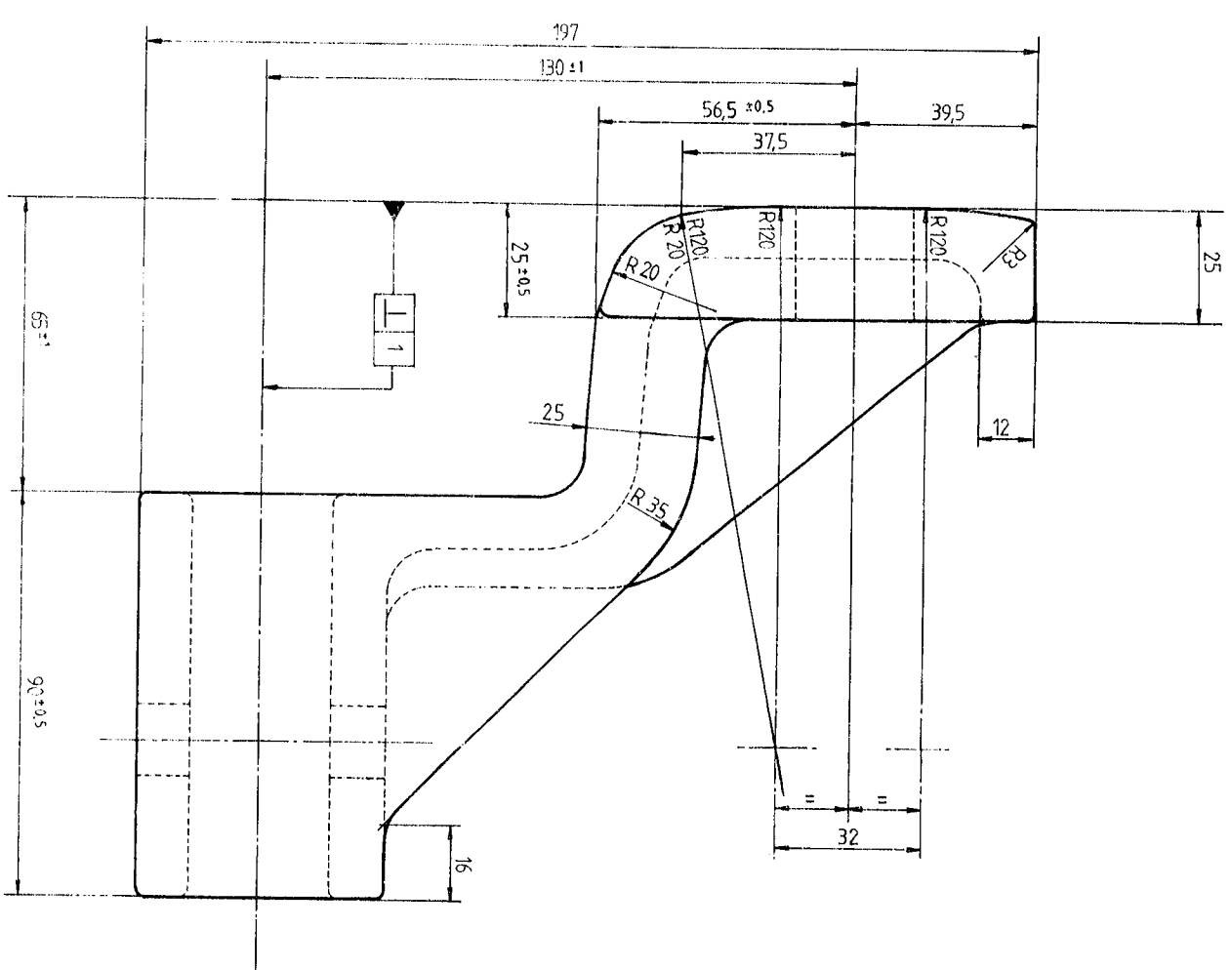
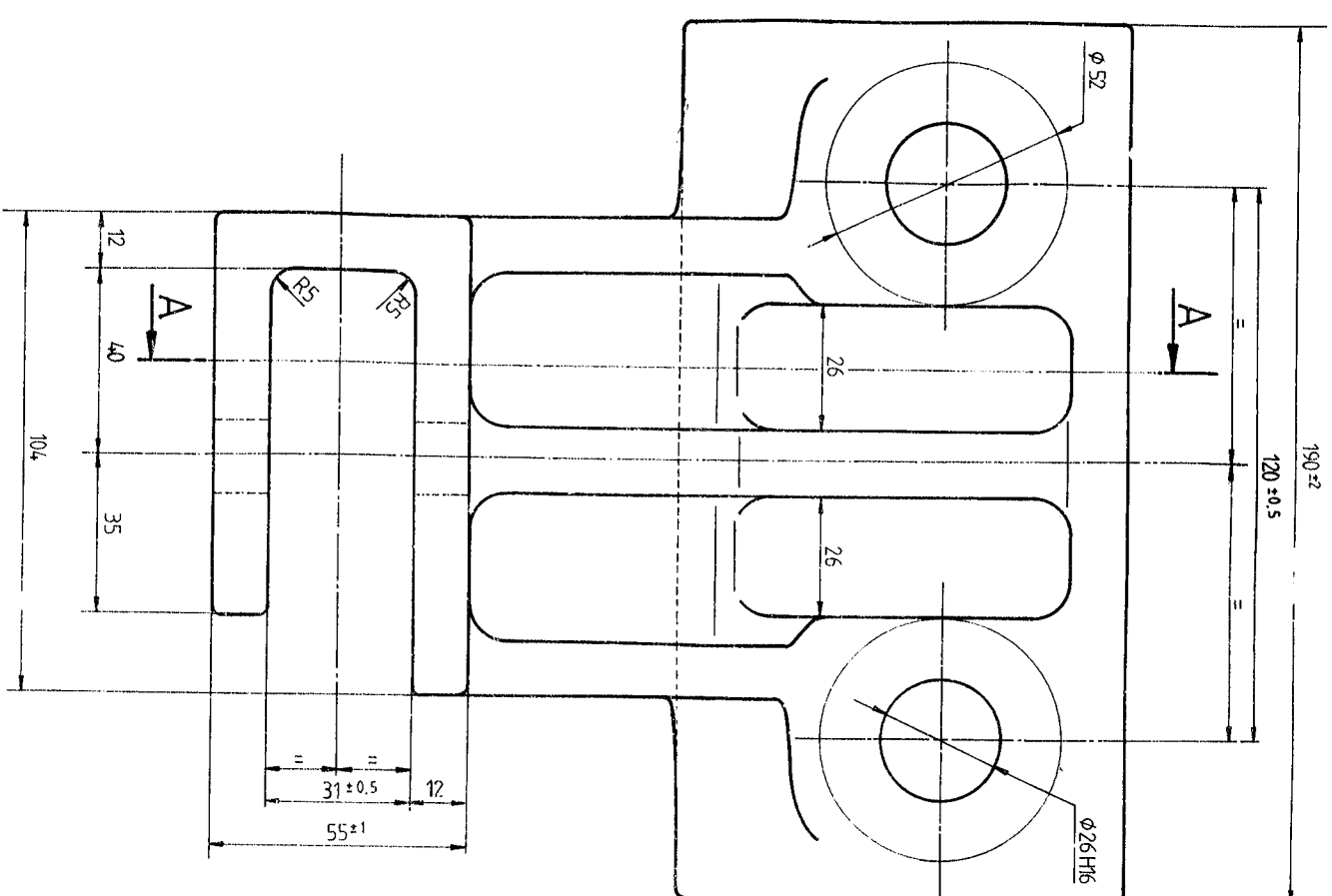
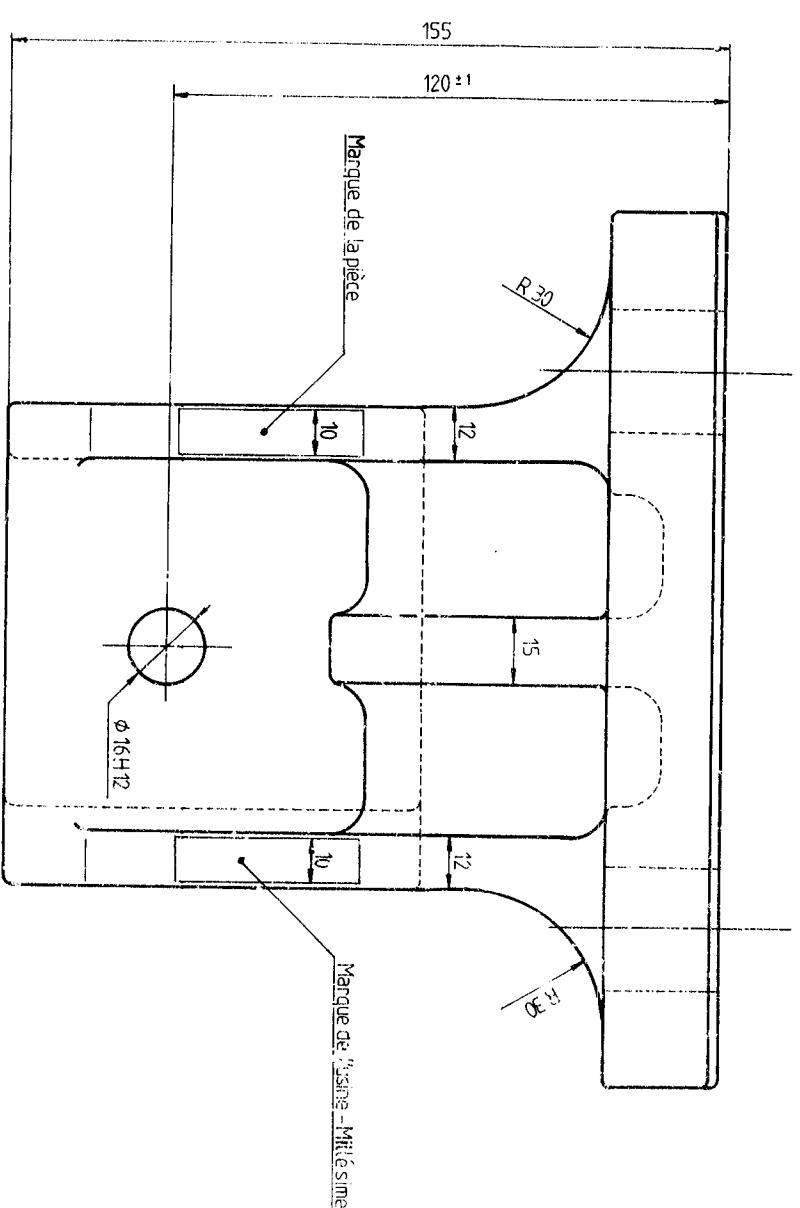

NOTA: - Traits de Ø 26 H 16 bruts de fondrière, mais bien tassés  
- Trou de Ø 16 H 12 percé  
- Marques en relief  
- Toutes surfaces: Ra  $\sqrt[125]{V}$ , trou Ø16 H12  $\sqrt[63]{V}$   
- CONTRÔLE MAGNÉTOSCOPIQUE: suivant les prescriptions de la ST 393.

[illegible]